



# The Guildhall Refurbishment Images.

**gillespie  
yunnie  
architects.**

# The Guildhall Existing Entrance.



# The Guildhall Proposed New Entrance Steps & Ramp.



# The Drake Room Existing Entrance.



# The Drake Room Proposed New Entrance Steps & Ramp.



# The Guildhall Existing Entrance Lobby.



# The Guildhall Refurbished Entrance Lobby.



# The Guildhall Existing First Floor Lounge.





# The Guildhall Proposed Basement Plan.

## Key:

1. Existing steps up to lobby and ground floor level
2. Existing lift refurbished
3. Existing bar replaced with new enclosure in same zone
4. Existing dumb waiter
5. Existing bar and lower lobby refurbished
6. Existing WCs replaced with new unisex and disabled cubicles with controlled central pass door
7. Extent of 1 hour fire protected lobby edged red
8. Provisional location of protected wheelchair refuge toned red
9. External fire escape route NB control of external gates to public domain

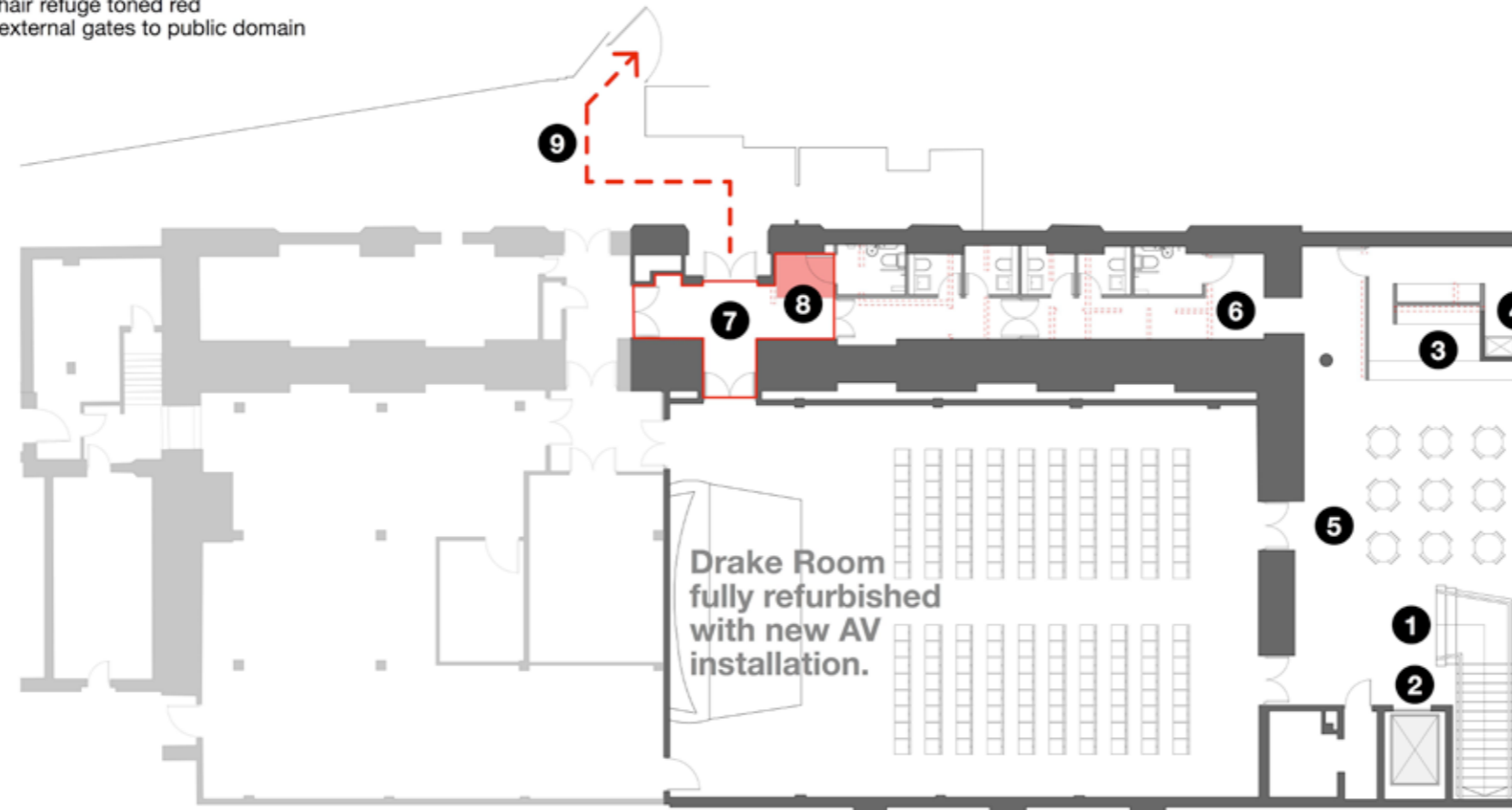

# The Guildhall Proposed Ground Floor Plan.

## Key:

1. New steps and ramp to main entrance
2. New ramp to inner lobby
3. New glazed meeting / break-out room
4. New furniture / equipment store room
5. Existing double entrance lift refurbished
6. New reception desk
7. Admin office
8. Toilets re-configured to create unisex cubicles + disabled WC
9. Existing main staircase refurbished
10. New platform lift within glazed enclosure
11. Existing NHS screening room suite
12. New glazed screens and lobby doors to improve connection with Drake Room
13. New glazed lobby doors to Drake Room
14. Existing lift refurbished
15. New steps and ramp to Drake Room
16. Reconfigured planter

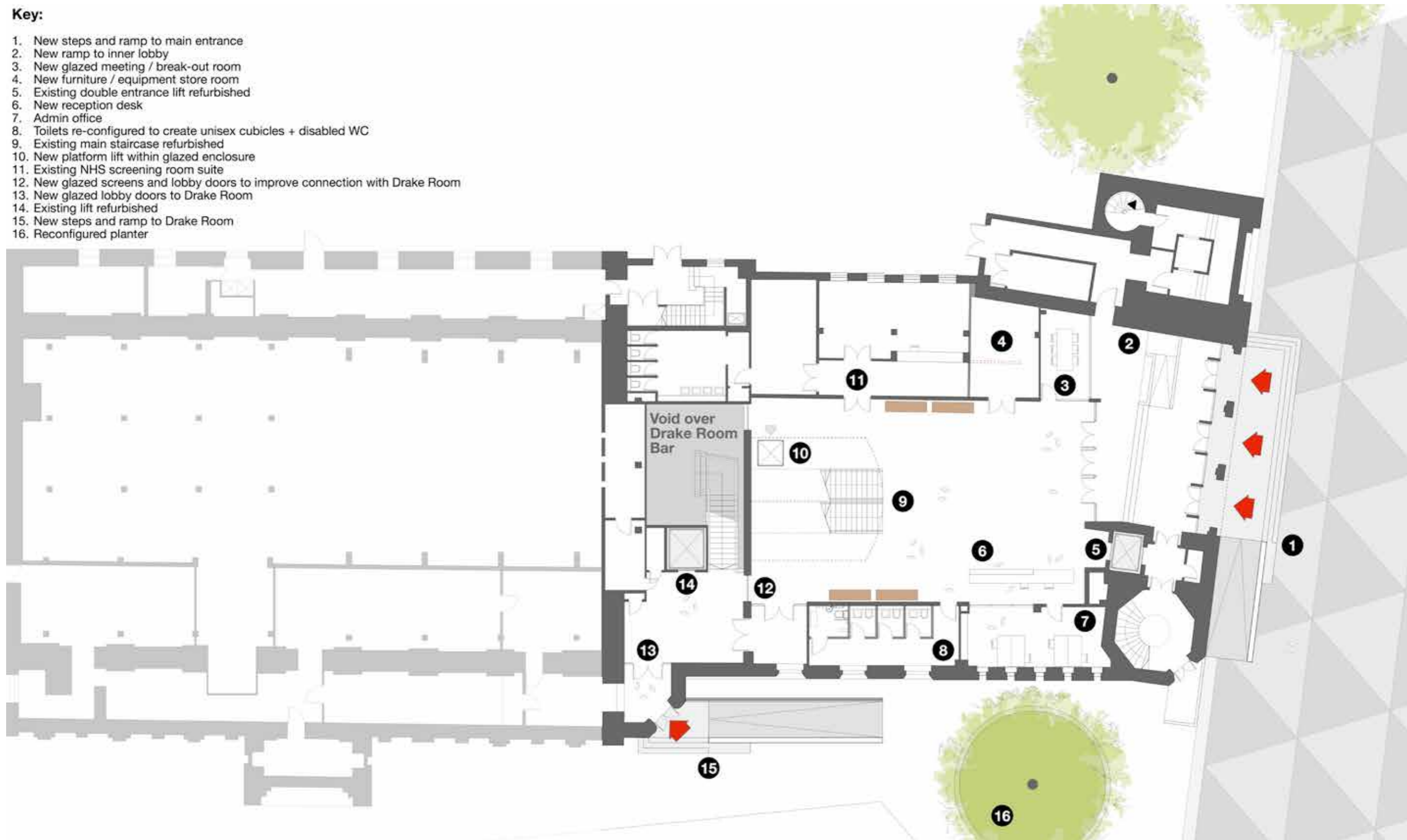

# The Guildhall Proposed First Floor Plan.

## Key:

1. Existing main staircases refurbished
2. New double entry platform lift and glazed enclosure opening onto both levels @ 90 degrees
3. New bar enclosure and fit-out within existing location
4. New lounge and seating areas
5. Existing WCs replaced with unisex and disabled cubicles
6. Existing hexagonal laylight ceiling over dashed
7. Existing lift refurbished
8. Existing commercial kitchen fully refurbished to specialist design
9. Existing dumb waiter installations to link kitchen locations
10. Furniture / equipment store

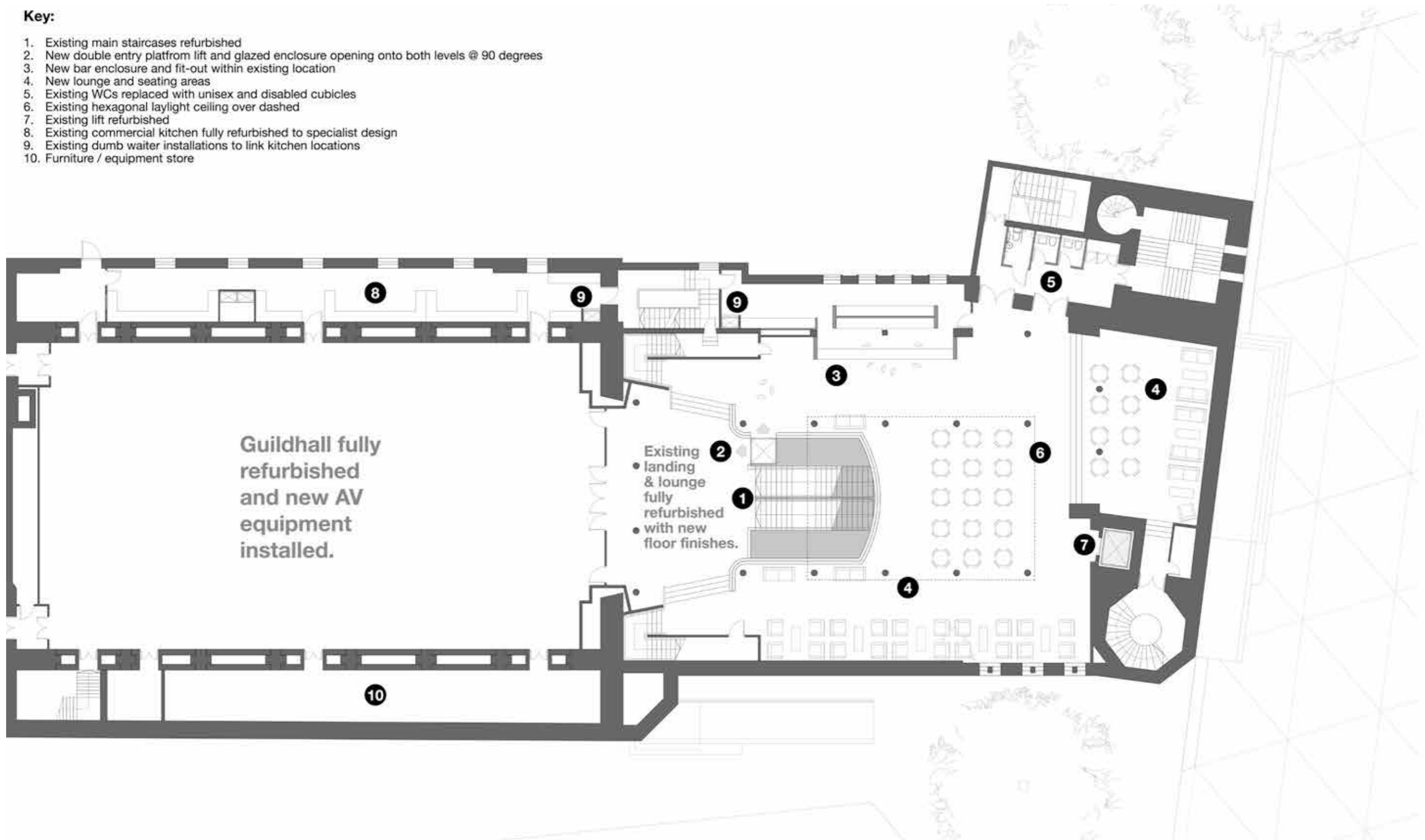

# The Guildhall Proposed Second Floor Plan.

## Key:

1. Existing landing to connect seminar spaces
2. Existing stairs
3. Existing lift installation refurbished
4. Astor Room refurbished
5. Charter Room refurbished
6. Existing office refurbished to form new seminar / function room
7. New furniture / equipment store
8. New windows to existing openings overlooking lightwell
9. Existing flat roof over first floor lounge
10. Existing WCs replaced with unisex and disabled cubicles
11. Existing balcony refurbished
12. Existing flat roof raised to form new internal lightwell

